

CVFU

Fjærstengende ventil innv. gjenge EPDM

- PVC tilbakeslagsventil
- Innvendig gjenge
- Fjærstengende AISI 316
- EPDM
- PN 16
- For både vertikal og horisontal montering.
- Fjær finnes i AISI 316 (V4A) eller PTFE belagt

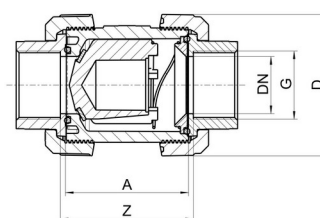

Artikkelnr	DN	G	A	D	Z
CVFU-E-R010	10	3/8"	62	53	67.5-71
CVFU-E-R015	15	1/2"	62	53	67.5-71
CVFU-E-R020	20	3/4"	70	63	76-79
CVFU-E-R025	25	1"	74	70	81-84
CVFU-E-R032	32	1 1/4"	84	85	90-96
CVFU-E-R040	40	1 1/2"	95	101	104-114
CVFU-E-R050	50	2"	119	121.5	121-134
CVFU-E-R065	65	2 1/2"	137	155	148-162
CVFU-E-R080	80	3"	163	188	183-211
CVFU-V-R010	10	3/8"	62	53	67.5-71
CVFU-V-R015	15	1/2"	62	53	67.5-71
CVFU-V-R020	20	3/4"	70	63	76-79
CVFU-V-R025	25	1"	74	70	81-84
CVFU-V-R032	32	1 1/4"	84	85	90-96
CVFU-V-R040	40	1 1/2"	95	101	104-114
CVFU-V-R050	50	2"	119	121.5	121-134
CVFU-V-R065	65	2 1/2"	137	155	148-162
CVFU-V-R080	80	3"	163	188	183-211