

CVIU

Fjærstengendeventil innv.lim EPDM

- PVC tilbakeslagsventil
- Innvendig lim
- Fjærstengende AISI 316(V4A)
- EPDM
- PN 16
- For både vertikal og horisontal montering.
- Fjær finnes i AISI 316 (V4A) eller PTFE belagt

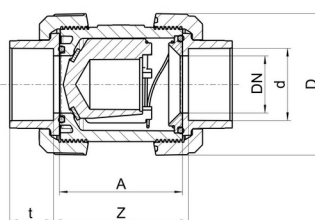

Artikkelnr	d	DN	A	D	t	Z
CVIU-E-016	16	10	62	53	14.5-16.5	67.5-71
CVIU-E-020	20	15	62	53	14.5-16.5	67.5-71
CVIU-E-025	25	20	70	63	17-19.5	76-79
CVIU-E-032	32	25	74	70	19.5-22.5	81-84
CVIU-E-040	40	32	84	85	22-26.5	90-96
CVIU-E-050	50	40	95	101	25-31.5	104-114
CVIU-E-063	63	50	119	121.5	29-38.5	121-134
CVIU-E-075	75	65	137	155	34.5-45	148-162
CVIU-E-090	90	80	163	188	38.5-55.5	183-211
CVIU-E-110	110	80	163	188	44-64	176-207
CVIU-V-016	16	10	62	53	14.5-16.5	67.5-71
CVIU-V-020	20	15	62	53	14.5-16.5	67.5-71
CVIU-V-025	25	20	70	63	17-19.5	76-79
CVIU-V-032	32	25	74	70	19.5-22.5	81-84
CVIU-V-040	40	32	84	85	22-26.5	90-96
CVIU-V-050	50	40	95	101	25-31.5	104-114
CVIU-V-063	63	50	119	121.5	29-38.5	121-134
CVIU-V-075	75	65	137	155	34.5-45	148-162
CVIU-V-090	90	80	163	188	38.5-55.5	183-211
CVIU-V-110	110	80	163	188	44-64	176-207