

M11M/NC

Kuleventil innv. sveis pneumatiskt (NC)

- PP-kuleventil
- Pneumatisk normalt stengt (NC)
- Fast sete, en side av ventilen kan demonteres under fullt trykk.
- PN 10
- Setetetninger i PTFE
- EPDM
- Max 80°C
- Tilkobling styreluft: G1/4" Namur
- Styretrykk: 5,5-8 Bar
- Optisk indikering

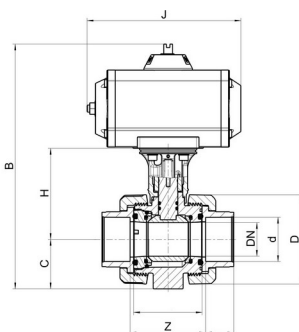

Artikkelnr	d	DN	B	C	D	Don	H	J	Z
M11M/NC-E-016	16	10	202	33	58	PPW	80	144	68.5
M11M/NC-E-020	20	15	202	33	58	PPWS	80	144	66.5
M11M/NC-E-025	25	20	215.5	40	68.5	PPWS	85.5	144	79
M11M/NC-E-032	32	25	220	43.5	75.5	PPWS	88	144	83
M11M/NC-E-040	40	32	250	51	92	PP00S	97	157	96
M11M/NC-E-050	50	40	261	56.5	108	PP00S	103	157	112
M11M/NC-E-063	63	50	275.5	64.5	127.5	PP00S	109.5	157	137
M11M/NC-E-075	75	65	350	85	160	PP10S	151.5	230	159.5
M11M/NC-E-090	90	80	376	100	196.5	PP10S	167	230	202.5
M11M/NC-E-110	110	80	376	100	196.5		167	230	204.5
M11M/NC-V-016	16	10	202	33	58	PPW	80	144	68.5
M11M/NC-V-020	20	15	202	33	58	PPWS	80	144	66.5
M11M/NC-V-025	25	20	215.5	40	68.5	PPWS	85.5	144	79
M11M/NC-V-032	32	25	220	43.5	75.5	PPWS	88	144	83
M11M/NC-V-040	40	32	250	51	92	PP00S	97	157	96
M11M/NC-V-050	50	40	261	56.5	108	PP00S	103	157	112
M11M/NC-V-063	63	50	275.5	64.5	127.5	PP00S	109.5	157	137
M11M/NC-V-075	75	65	350	85	160	PP10S	151.5	230	159.5
M11M/NC-V-090	90	80	376	100	196.5	PP10S	167	230	202.5
M11M/NC-V-110	110	80	376	100	196.5		167	230	204.5

Med forbehold om konstruksjonsendringer og tekniske endringer. Kan endres uten varsel.

gpa.no | info@gpa.no | +47 64 85 68 00