

S4IC

Kuleventil Industri

- CPVC-kuleventil
- Innvendig lim
- Håndtaket er utstyrt med sikkerhetslås og øye for TAG-merking/ hengelås.
- Fast sete, en side av ventilen kan demonteres under fullt trykk.
- Setetetninger i PTFE
- PN 16
- EPDM

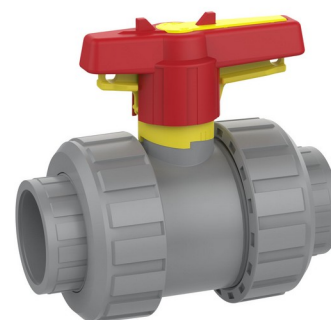
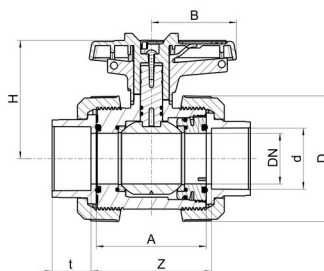

| Artikkelnr | d | DN | A | B | D | H | t | Z |
|------------|----|----|------|------|-------|-------|------|-------|
| S4IC-E-016 | 16 | 10 | 62 | 40 | 53 | 72 | 16.5 | 68 |
| S4IC-E-020 | 20 | 15 | 62 | 40 | 53 | 72 | 16.5 | 67 |
| S4IC-E-025 | 25 | 20 | 70 | 51.5 | 62.5 | 78.5 | 19.5 | 76 |
| S4IC-E-032 | 32 | 25 | 73.5 | 51.5 | 70 | 81.5 | 22.5 | 79.5 |
| S4IC-E-040 | 40 | 32 | 83.5 | 64 | 84.5 | 100 | 26.5 | 89.5 |
| S4IC-E-050 | 50 | 40 | 94.5 | 73 | 100 | 107.5 | 31.5 | 102.5 |
| S4IC-E-063 | 63 | 50 | 108 | 85 | 119.5 | 116.5 | 38.5 | 118 |
| S4IC-V-016 | 16 | 10 | 62 | 40 | 53 | 72 | 16.5 | 68 |
| S4IC-V-020 | 20 | 15 | 62 | 40 | 53 | 72 | 16.5 | 67 |
| S4IC-V-025 | 25 | 20 | 70 | 51.5 | 62.5 | 78.5 | 19.5 | 76 |
| S4IC-V-032 | 32 | 25 | 73.5 | 51.5 | 70 | 81.5 | 22.5 | 79.5 |
| S4IC-V-040 | 40 | 32 | 83.5 | 64 | 84.5 | 100 | 26.5 | 89.5 |
| S4IC-V-050 | 50 | 40 | 94.5 | 73 | 100 | 107.5 | 31.5 | 102.5 |
| S4IC-V-063 | 63 | 50 | 108 | 85 | 119.5 | 116.5 | 38.5 | 118 |